

Installation Instructions **Bath Swing Door**

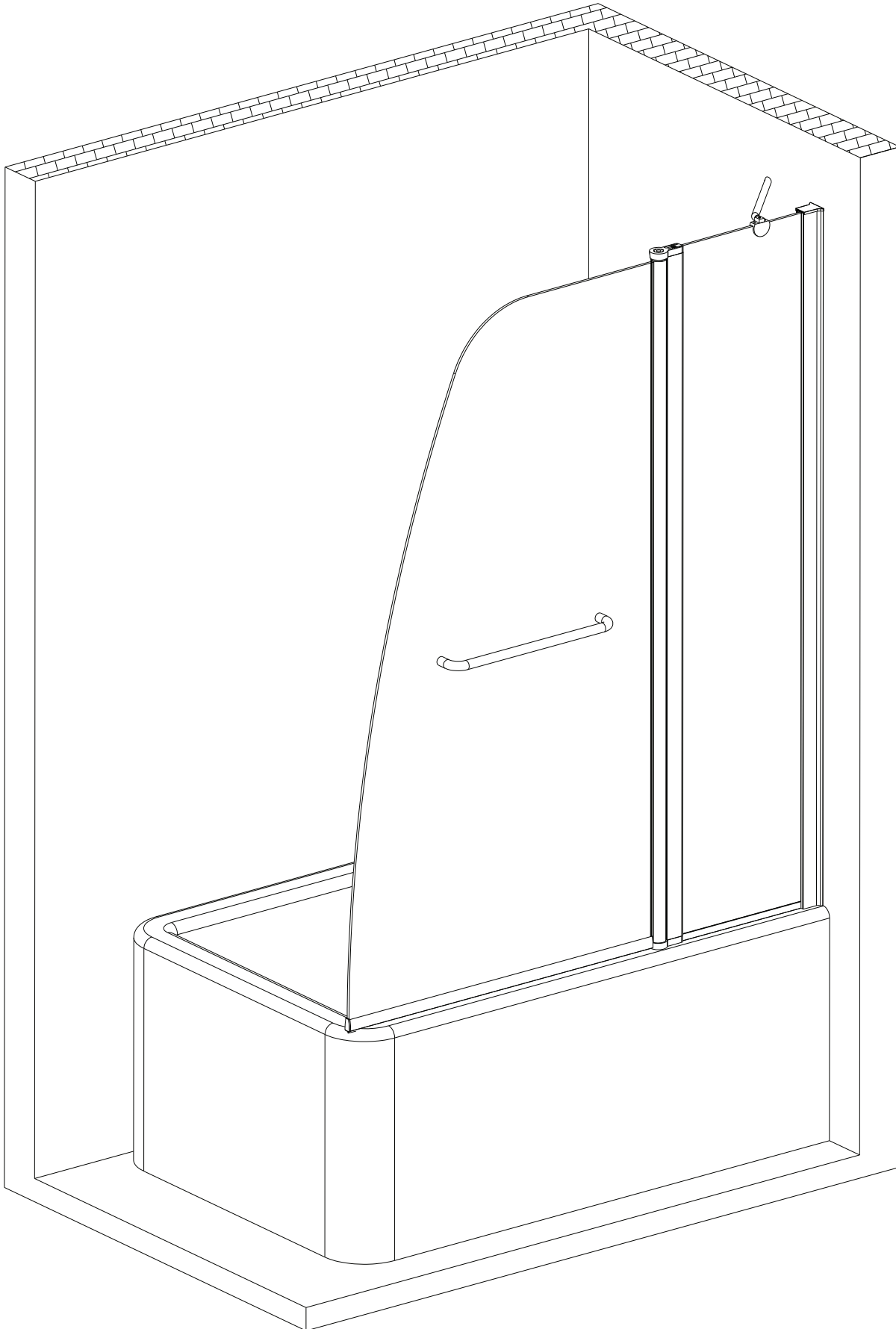

Analytic Drawings

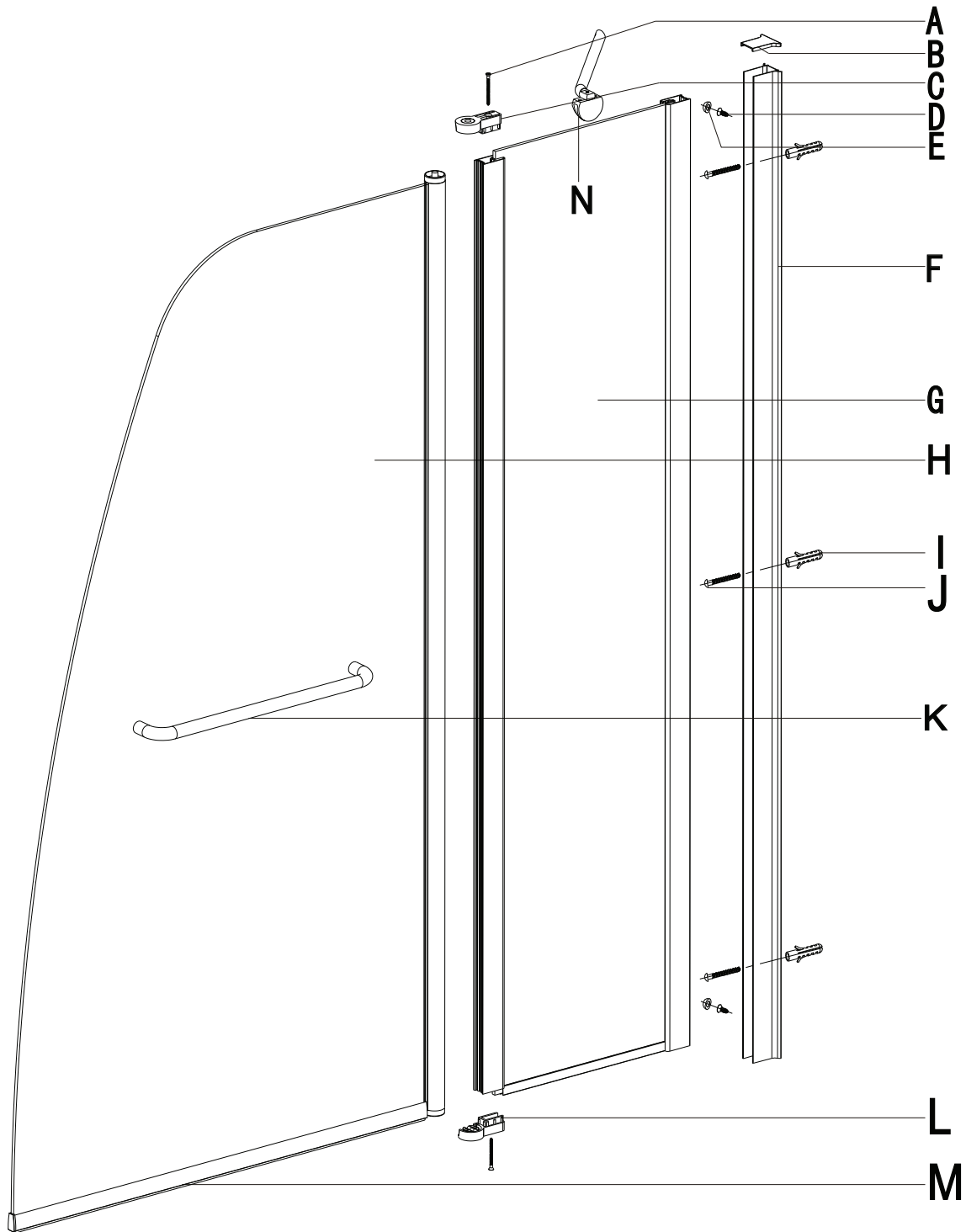

*1. PART

A	*2+1	B	*1	C	*1	D	*2+1	E	*2+1	F	*1	G	*1	H	*1	I	*3+1	J	*3+1
ST4X30		Ornamental		L		ST4X12						Fixed Door		Movable Door				ST4X35	

*2. TOOLS

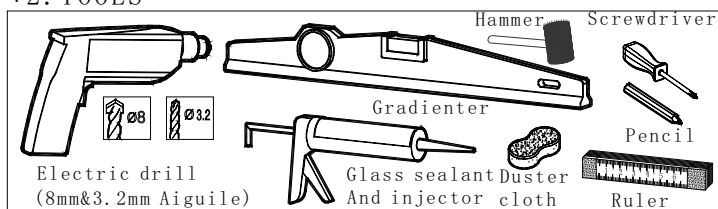

K	*1	L	*1	M	*1	N	*1
Handle		R		Waterproof			

Packing methods for Block-axis (subject to final articals,drawings only for reference)

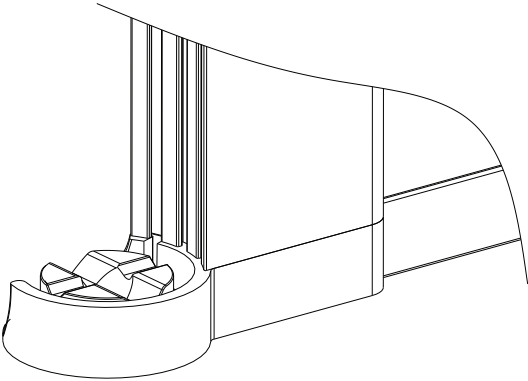

(Installing the block axia)
(Pattern 1)

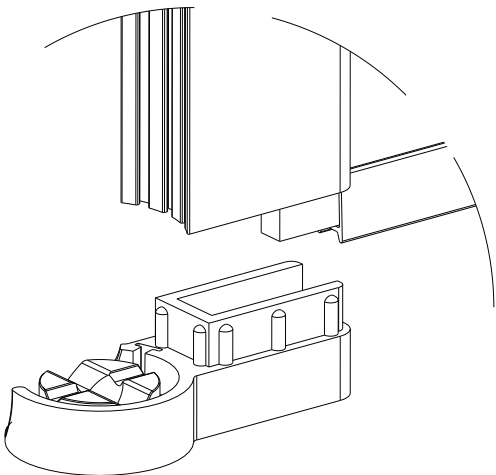

(Separating the block axis)
(Pattern 2)

